

Standard PFCV (Isolation Balanced)

These proportional valves combine the advantages of both inlet balanced and internally balanced valves. These valves are pressure balanced and are insensitive to the inlet and outlet pressure. The take-off of the valve remains consistent at different inlet pressures and they can be used with any outlet pressures. These proportional valves offer isolation of the fluid medium from the solenoid and offer limited internal volume. Signal Amplifiers are also available to control these valves using a 0 - 5V, 0 - 10V or 4 - 20 mA control signal.

General Performance Specification

Function:	2 Way Normally Closed
Orifice Size Range:	.234" to .625"
Hysteresis:	< 10%
Time Response:	< 35 msec
Pressure Range:	0 - 135 PSI
Seal Material:	Nitrile, FKM
Temperature Range:	
Nitrile:	-40 to 250° F
FKM:	-20 to 400° F
Wetted Material:	Al & 300 Series SS
Fluid:	Gases & Liquids
Voltage Range:	6 to 24 volts
Lead Wires:	22 AWG 12" long
Weight - Al Base:	22 - 27 Oz.

Typical Flow Characteristics

Std PFCV Isolation Balanced 0.375 12V

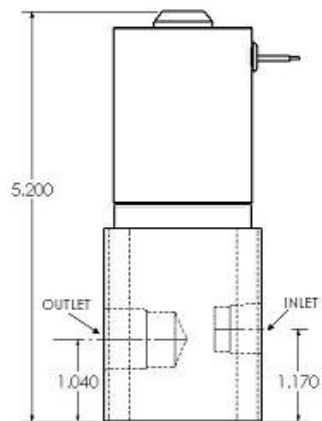
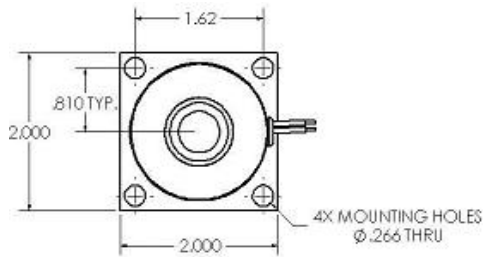
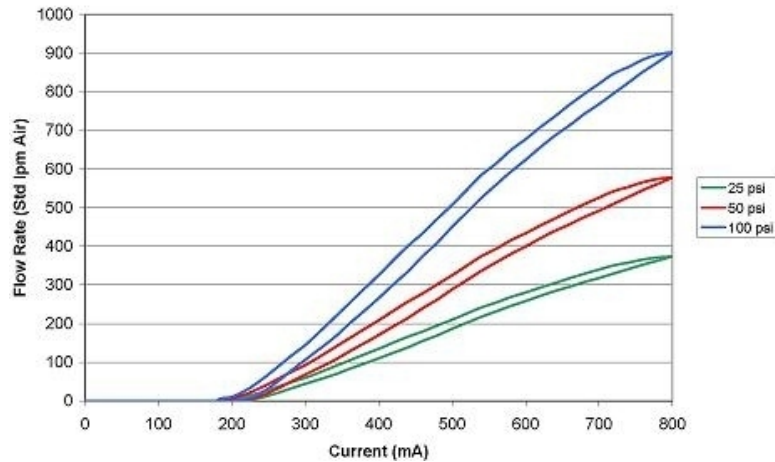

ISOLATION BALANCED SPECIFICATIONS

PART NUMBER	ORIFICE SIZE	VOLT	POWER WATTS	INLET NPT	OUTLET NPT	FLOW @ 100 PSI LPM	PRICE (EA)
203301	0.234	6	6.00	1/4	1/4	500	\$557.50
203302	0.316	6	6.00	1/2	3/8	700	\$557.50
203303	0.375	6	6.00	1/2	3/8	900	\$557.50
203305	0.625	6	6.00	1/2	3/8	1300	\$836.25
203309	0.234	12	8.75	1/4	1/4	500	\$557.50
203310	0.316	12	8.75	1/2	3/8	700	\$557.50
203311	0.375	12	8.75	1/2	3/8	900	\$557.50
203313	0.625	12	8.75	1/2	3/8	1300	\$836.25
203317	0.234	24	17.50	1/4	1/4	500	\$557.50
203318	0.316	24	17.50	1/2	3/8	700	\$557.50
203319	0.375	24	17.50	1/2	3/8	900	\$557.50
203321	0.625	24	17.50	1/2	3/8	1300	\$836.25